

MDT 860

Quickstart Guide



How to log on

The Driver ID Log on screen will appear on the MDT860 immediately after the ignition is turned on.



Using the numeric keypad enter the complete Driver PIN.

Press ✓ to confirm the Driver PIN. The MDT860 will then send the PIN number back to the OnlineAVL application for checking. Confirmation may take a few minutes depending on cellular network coverage.

How to Read and Reply to a Message

Receiving Messages

When a message is sent to the MDT860, a New Message pop up screen will be displayed, accompanied by a beeping signal, regardless of what screen is being viewed.



Press ✓ to open the Inbox screen and read a message.

Press ✕ to cancel and close the new message pop-up screen. The message can then be viewed later from the Inbox menu.

Reading Messages

In the Inbox screen, use the ▲ and ▼ on the 4-way cursor key to select a message.

Press ✓ to open the message.

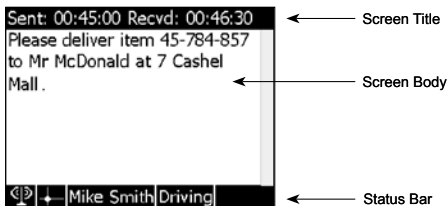

The screen title of the read message screen displays the time that the message was sent and the time that the message was received at the MDT860.

Replying to a Received Message

Press ✓ to reply to the message. The Process Message screen will be displayed.

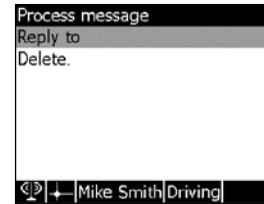

Select Reply To. The Send A Message screen will be displayed.



Select either the free form text message or a canned message.

To enter a free form text message, see using multi-tap.

How to use Multi-Tap Text Entry

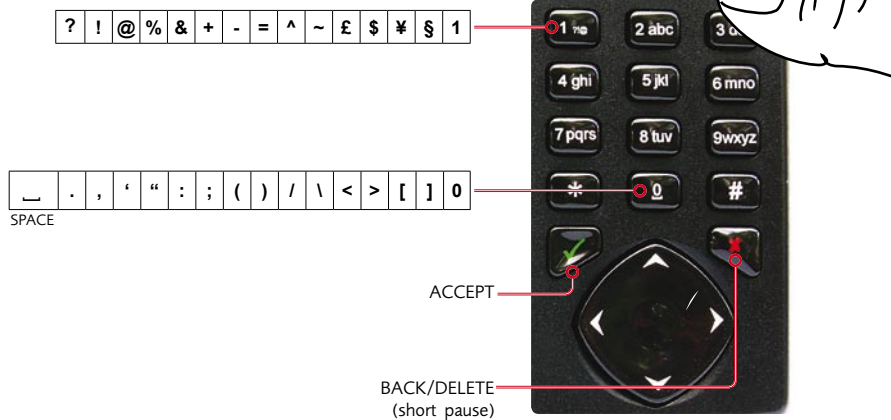

MDT000777A-G

Lon 174° 44.480'E



Lat 36° 48.422'S